

PARTS (NOT TO SCALE)

1020 Straight

Vertical Pole Sections

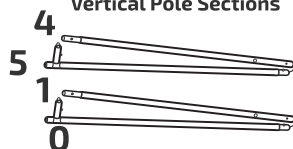

Bottom Horizontal Pole



Support Pole



Radius Top Corner Sections

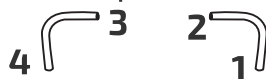

Top Horizontal Pole



Feet

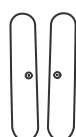

Gloves



Optional Half Feet



NOT SUPPLIED WITH KIT AND THEY ARE SOLD SEPARATELY

1024 Straight

Extension poles (x2)

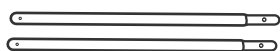

NOTE: The extension poles are used for 1024 Straight frames

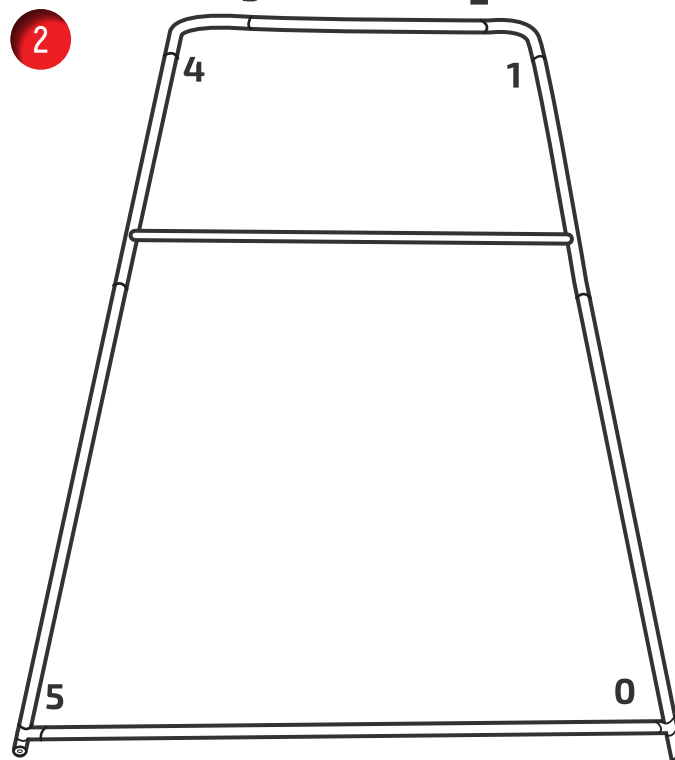
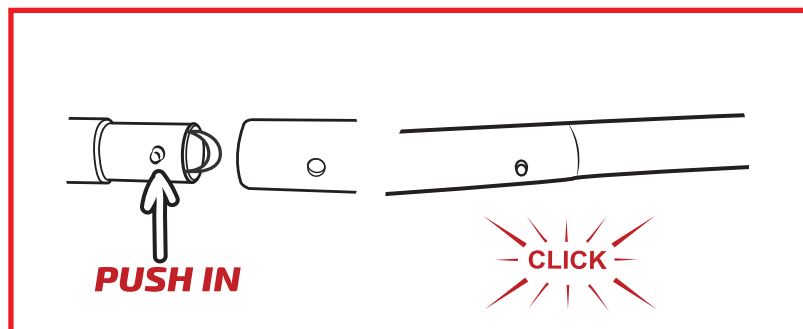
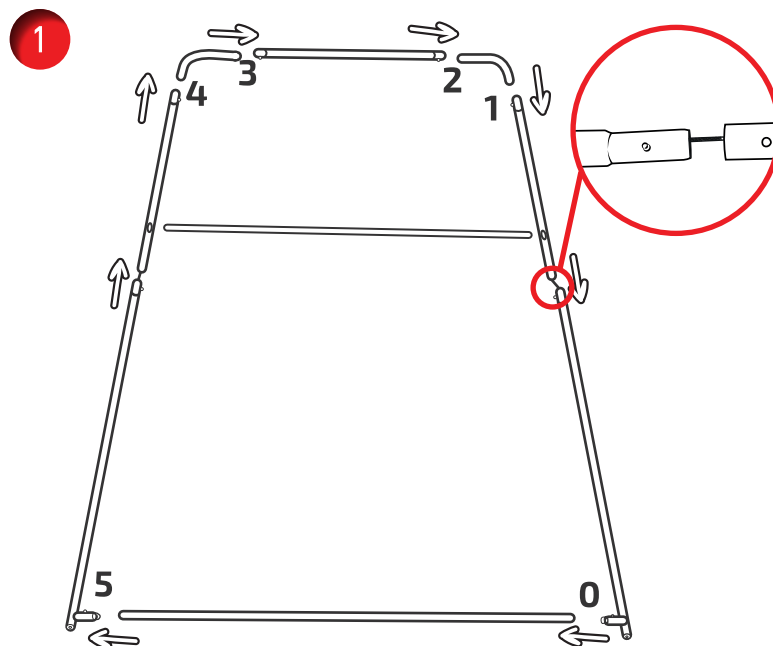

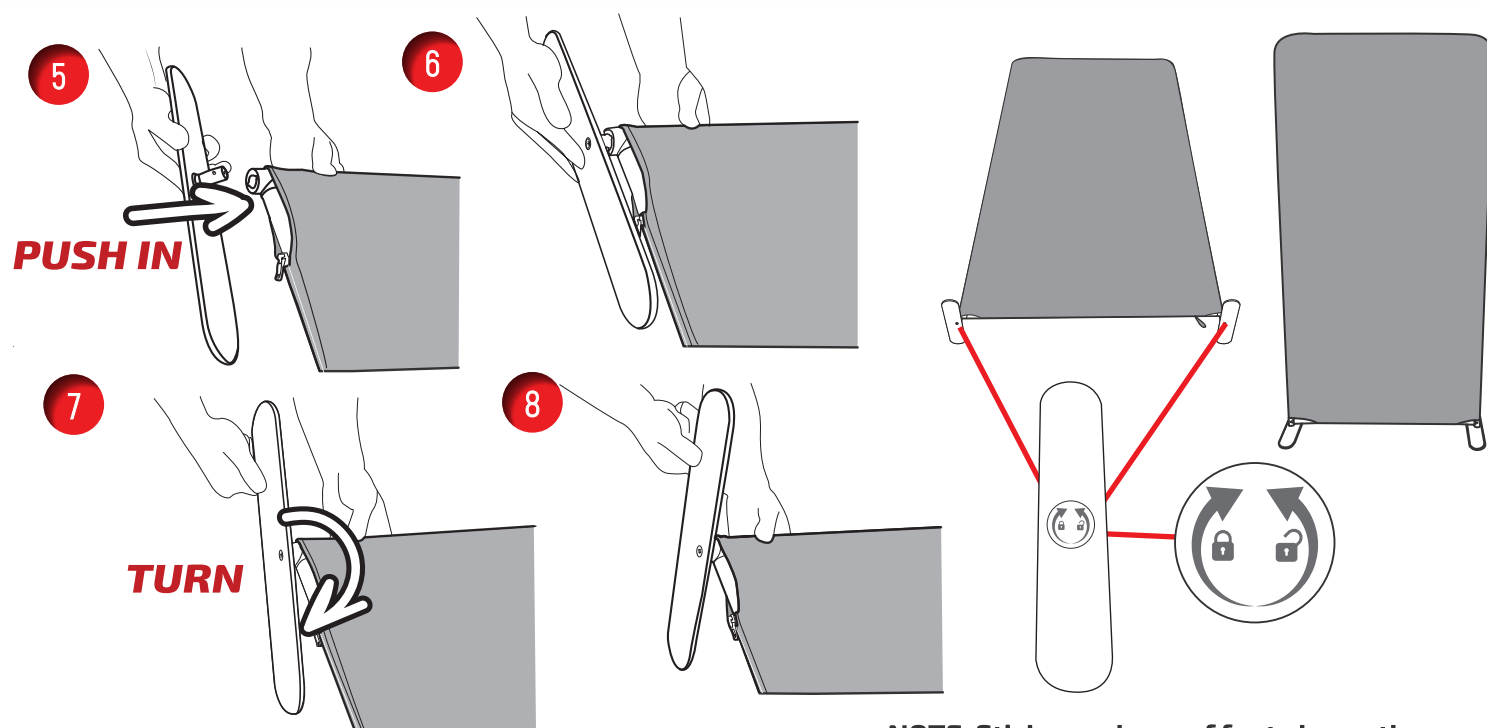
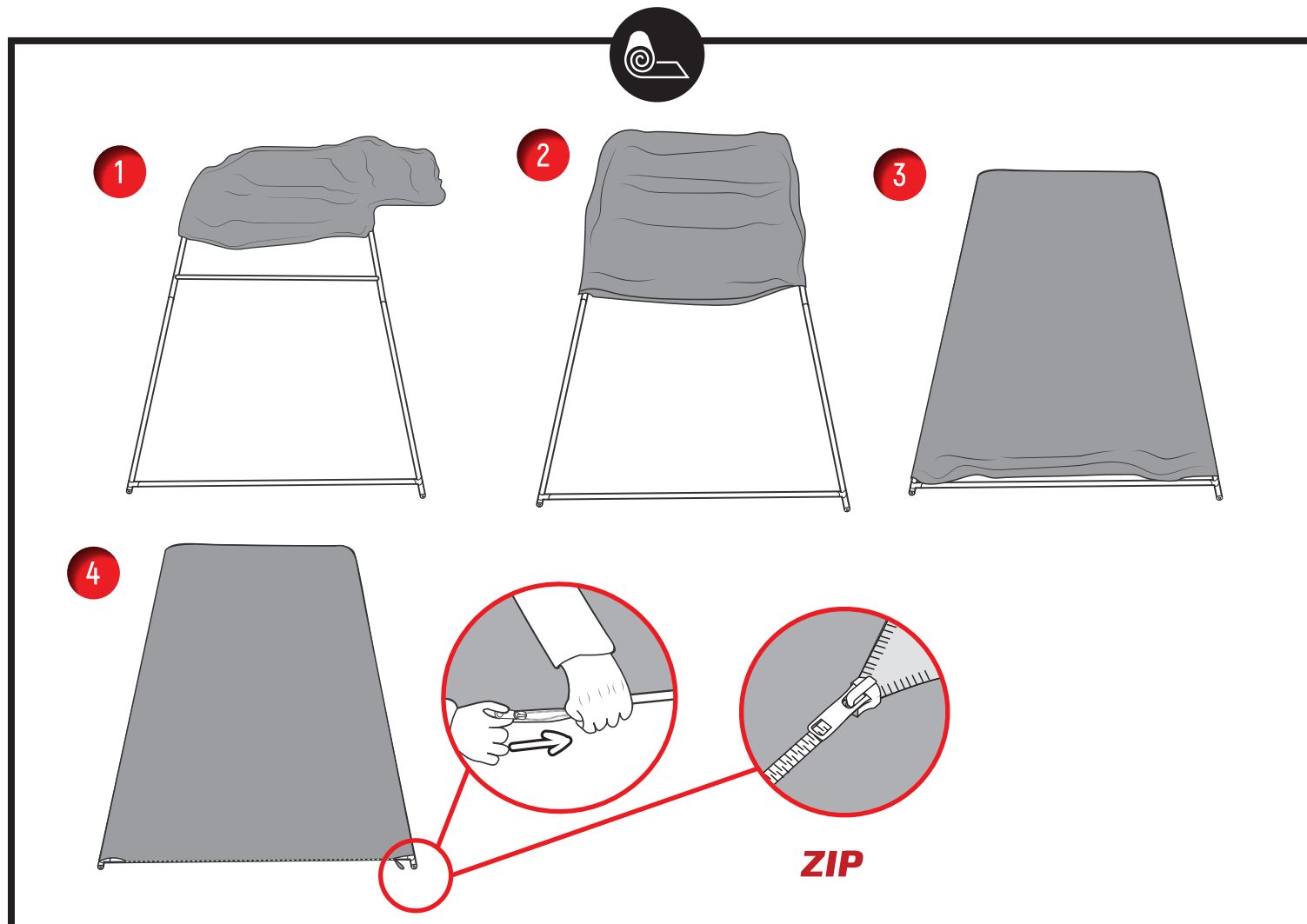

Turn clockwise to lock foot in position
Turn anti-clockwise to unlock foot

NOTE: Sticker on base of foot shows the directions for locking/unlocking foot

NOTE: TWO POSITIONS FOR THE FEET (SEE OPTION 1 FOR SECOND POSITION)

OPTIONAL (EXTENSION KIT)

NOTE: EXTENSION SECTION SUPPLIED WITH 1024 STRAIGHT FRAME

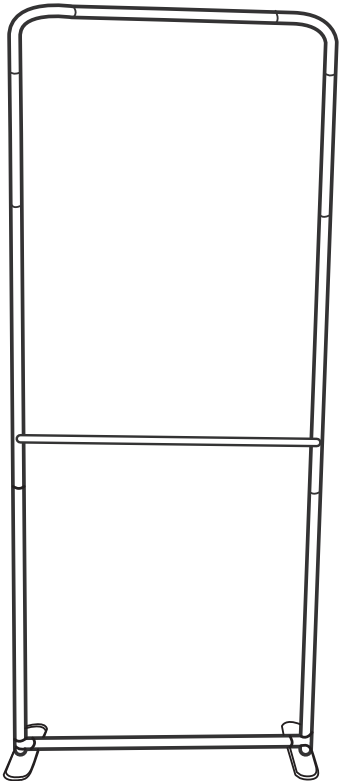
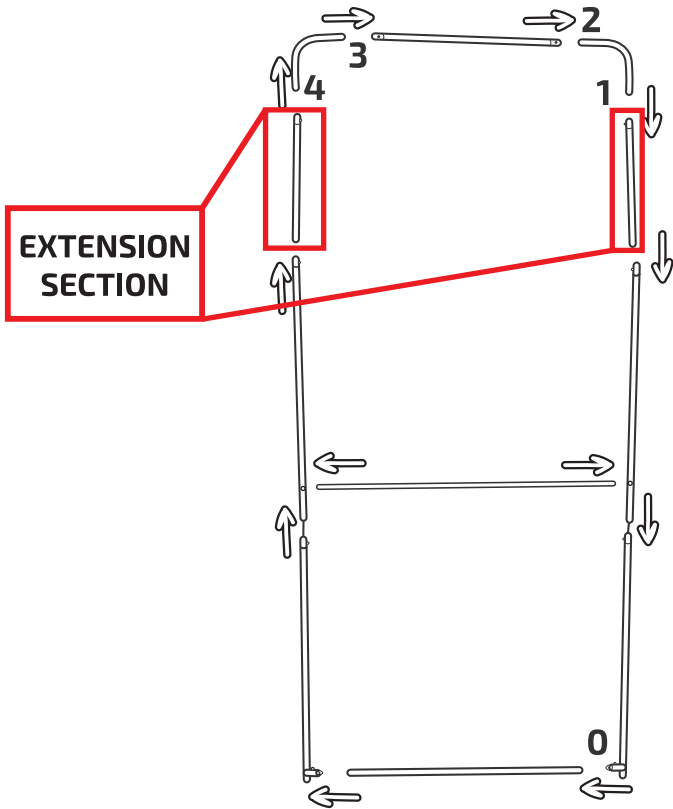

OPTIONAL (HALF FEET)

OPTION 1 **NOTE: HALF FEET CAN BE POSITIONED ONTO THE FRAME TWO DIFFERENT WAYS**

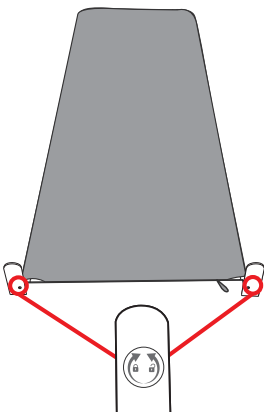
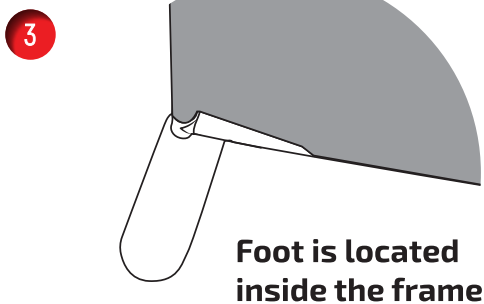
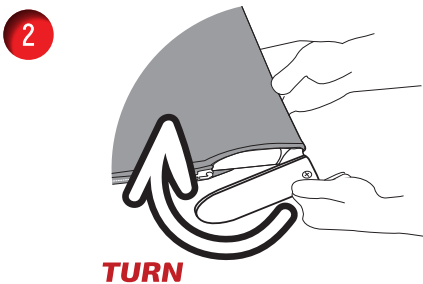
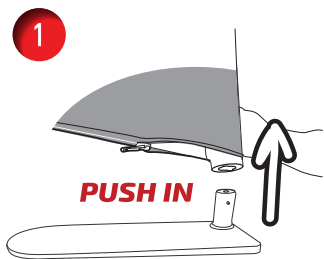

Turn clockwise to lock foot in position
Turn anti-clockwise to unlock foot

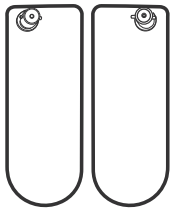



OPTION 2

1

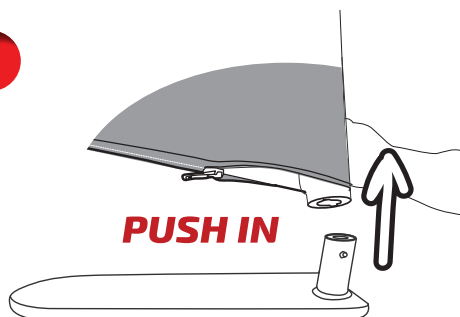

2

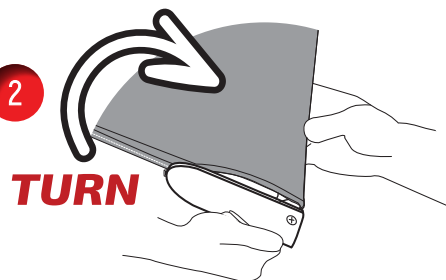

3

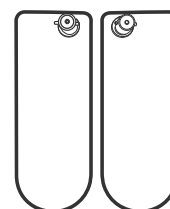
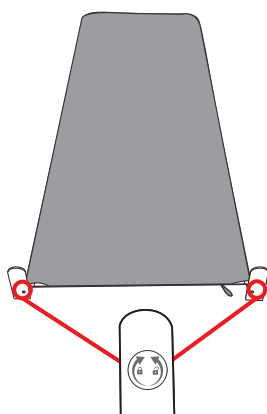
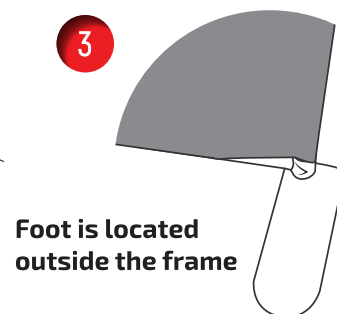

Turn clockwise to lock foot in position
Turn anti-clockwise to unlock foot



CONNECTING MULTIPLE FRAMES NOTE: 1024 STRAIGHT NOT INCLUDED

Remove one foot
from second frame
and align both
frames on one foot

NOTE: FOLLOW
OPTION 2 FOR HALF
FEET TO CONNECT
TWO FRAMES ON
ONE FOOT

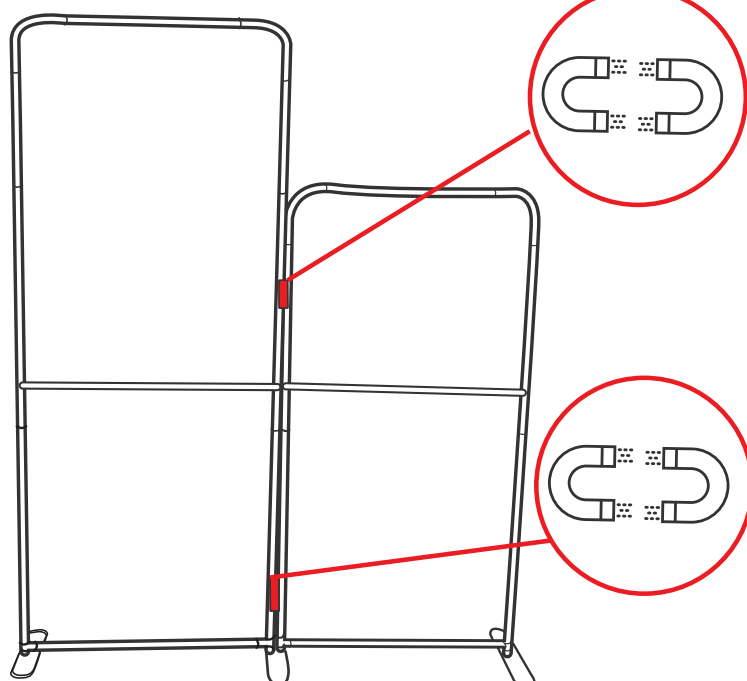
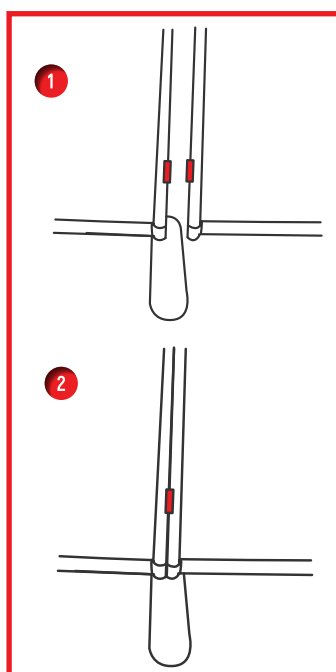

1024 Straight Frame and 1020 Straight Frame