

Flextile Assembly Instructions

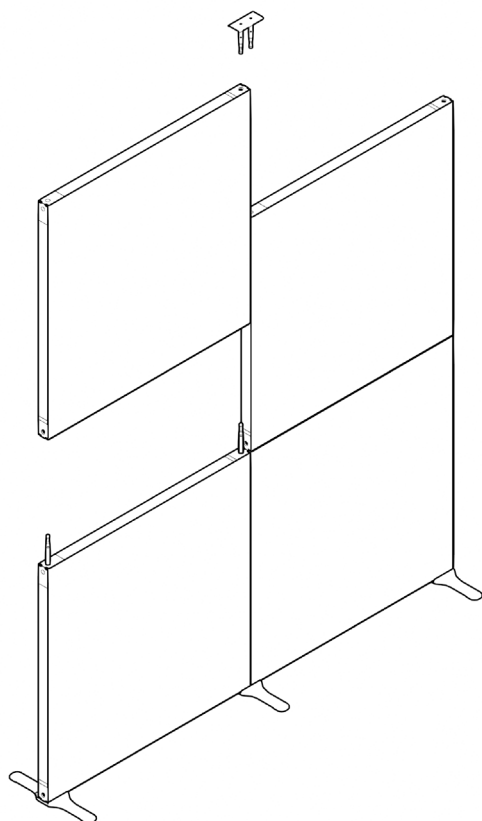

spennare) >

Flextile Assembly Instructions
Version 1. Copyright Spennare AB, 2024.

Spennare Headquarters:
Danvikcenter, Hästholmsvägen 32
131 30 Nacka
Sweden

+46 8 462 66 50 (switchboard)
info@spennare.com

Contents

System introduction

Frame assembly	4
Mounting the fabric print.....	5
Connections.....	7
Accessory kits	8

Assembly instructions

Start/end of row	9
Straight connection with Foot connector	10
45° connection with Foot connector.....	11
90° connection with Foot connector.....	12
90° connection with Foot plate.....	13
T-connection with Foot plate	14
X-connection with Foot plate	15
X-connection.....	16
Y-connection.....	17
Curtain kit.....	18
Desk kit.....	20
Wall mounting kit	21
Illumination kit.....	22

System overview

Components.....	23
-----------------	----

SYSTEM INTRODUCTION

Frame assembly

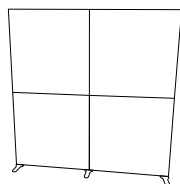

Example: 2x2 frames

Setting up the Foot connectors

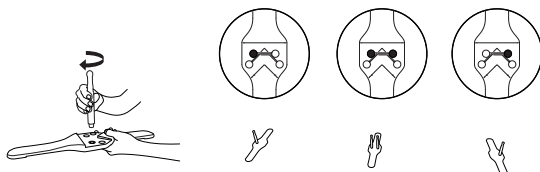

Unfolding a Frame

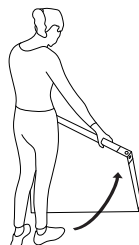
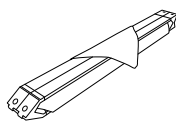

Assembly

1

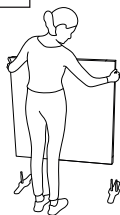

2

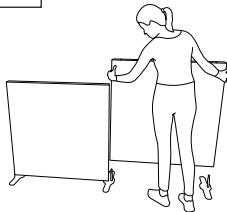

3

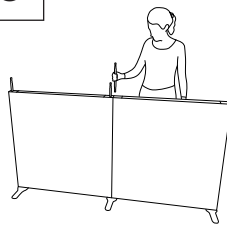

4

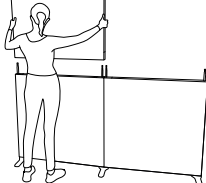

5

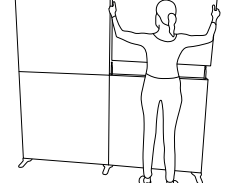

6

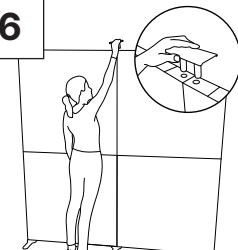

Mounting the fabric print

Fabric prints mounted on the inside of the fold can stay on the frame when folding it.

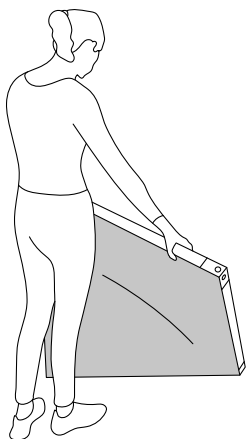

Fabric prints can be mounted one on each frame, or span across several frames.

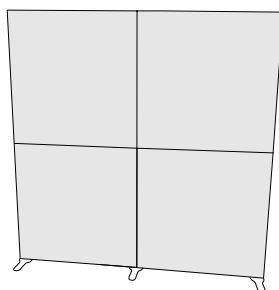
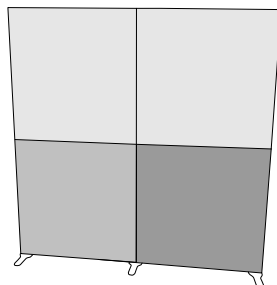
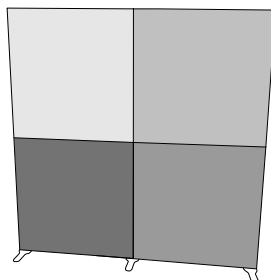

Mounting the fabric print

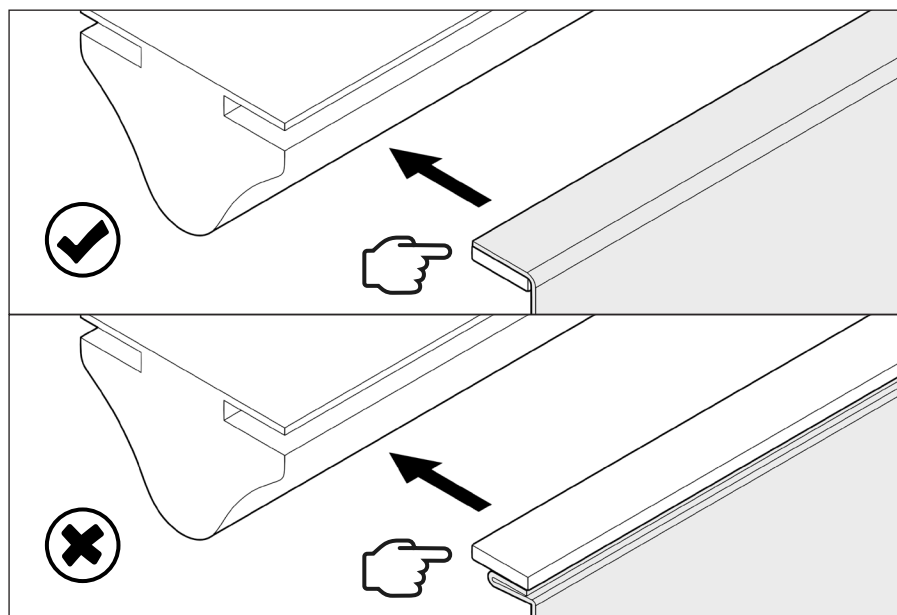
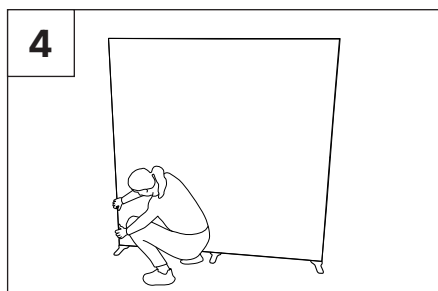
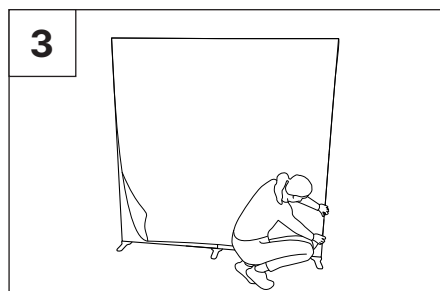
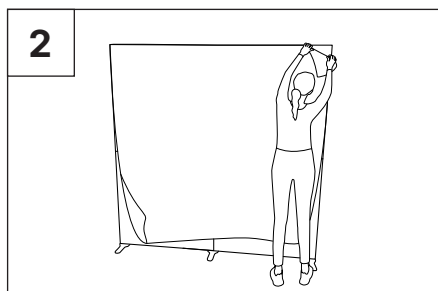
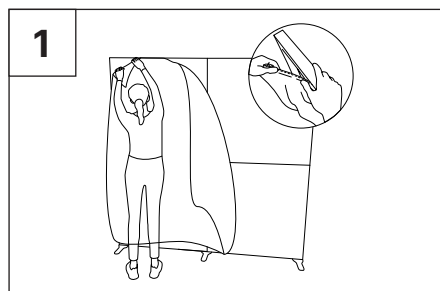

Connections

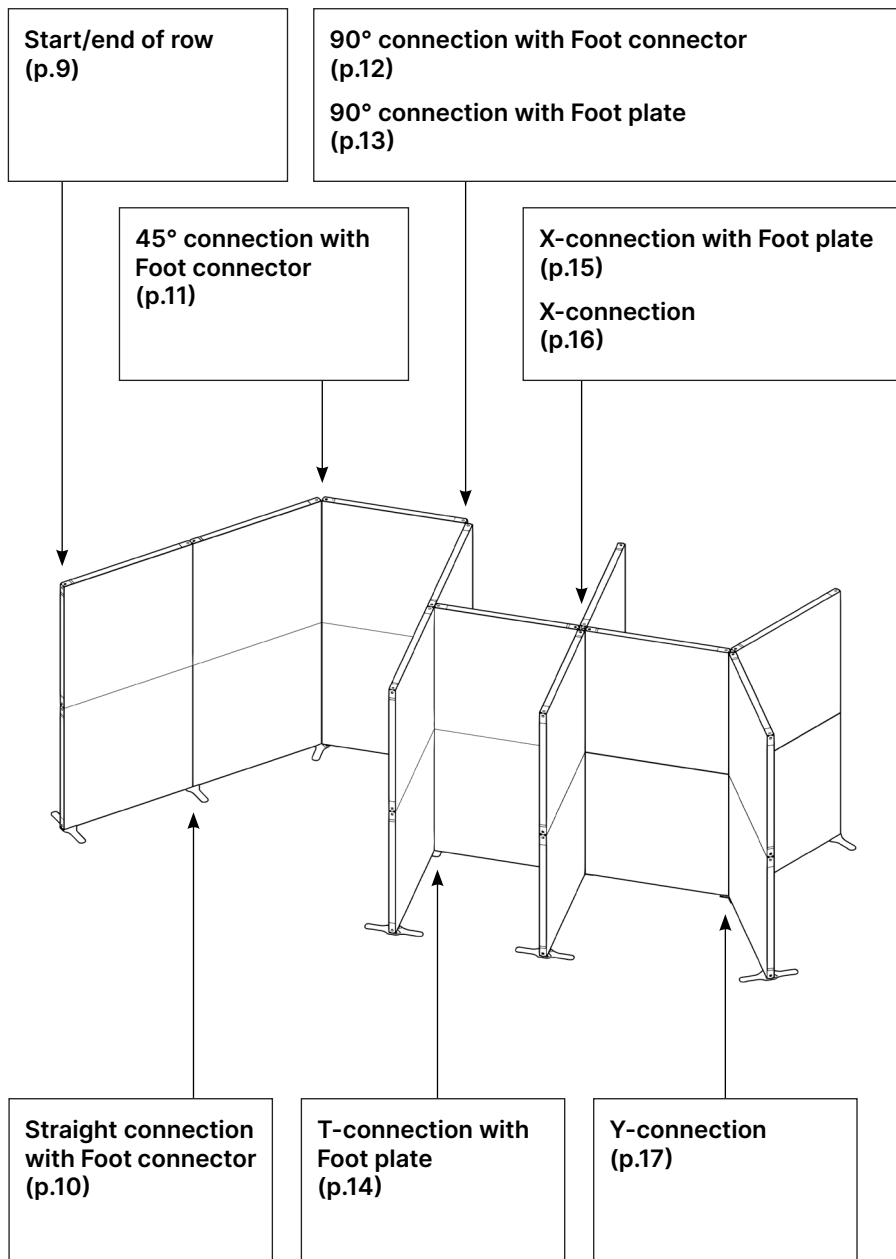

Accessory kits

**Curtain kit
(p.18)**

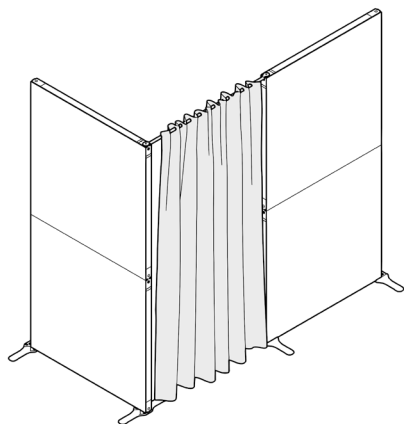

**Desk kit
(p.20)**

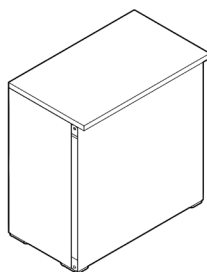

**Wall mounting kit
(p.21)**

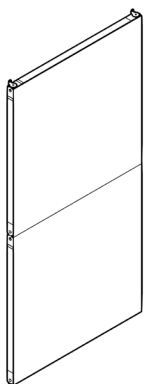

**Illumination kit
(p.22)**

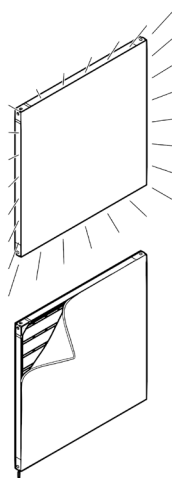

Start/end of row

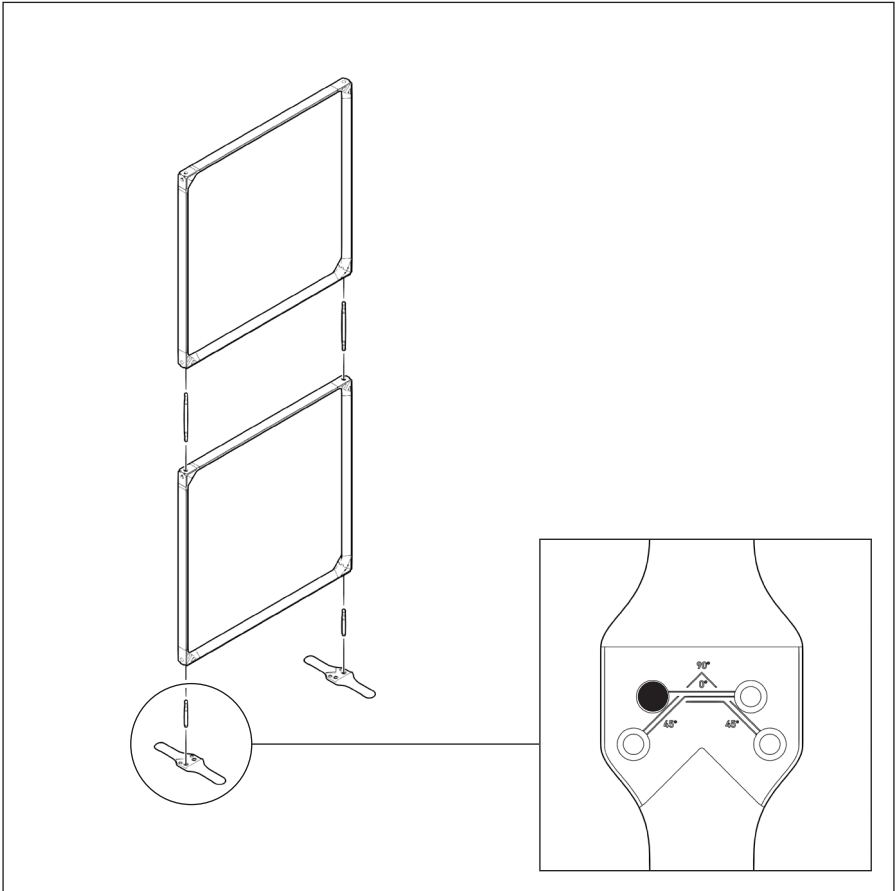

1. Fasten a **Foot rod** in one of the holes on the **Foot connector** marked "0°"
2. Mount a **Frame** onto the **Foot rod**
3. Insert a **Connector rod** in the top hole of the **Frame**
4. Continue stacking **Frames** and **Connector rods** to the desired height

Straight connection with Foot connector

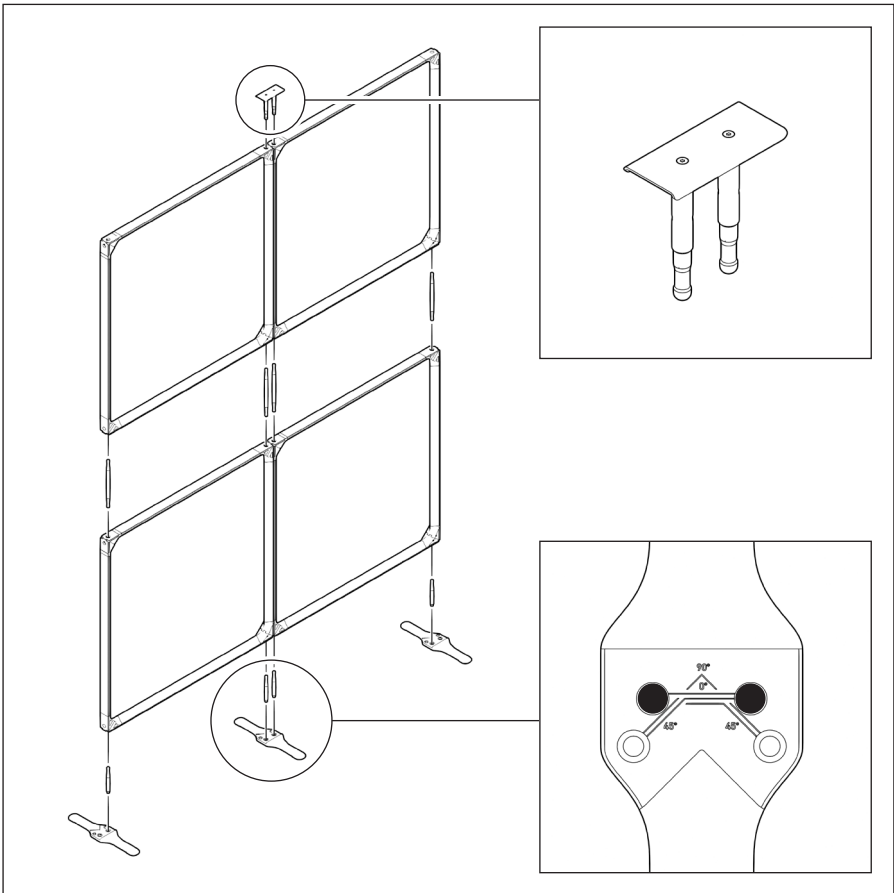

1. Fasten two **Foot rods** in the holes on the **Foot connector** marked "0°"
2. Mount two **Frames** onto the **Foot rods**
3. Insert **Connector rods** in the top holes of the **Frames**
4. Continue stacking **Frames** and **Connector rods** to the desired height
5. Place a **Top connector Straight** on top

45° connection with Foot connector

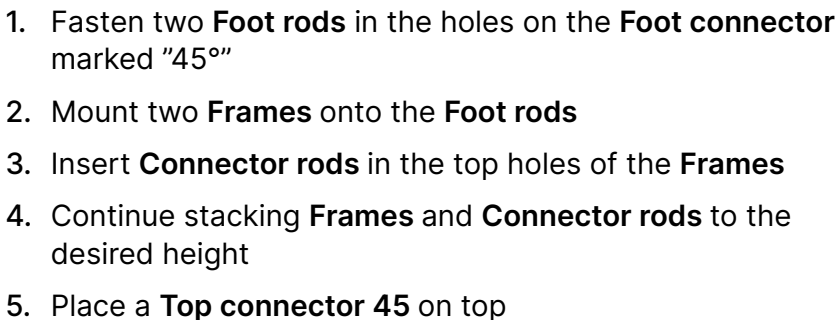

ASSEMBLY INSTRUCTIONS

90° connection with Foot connector

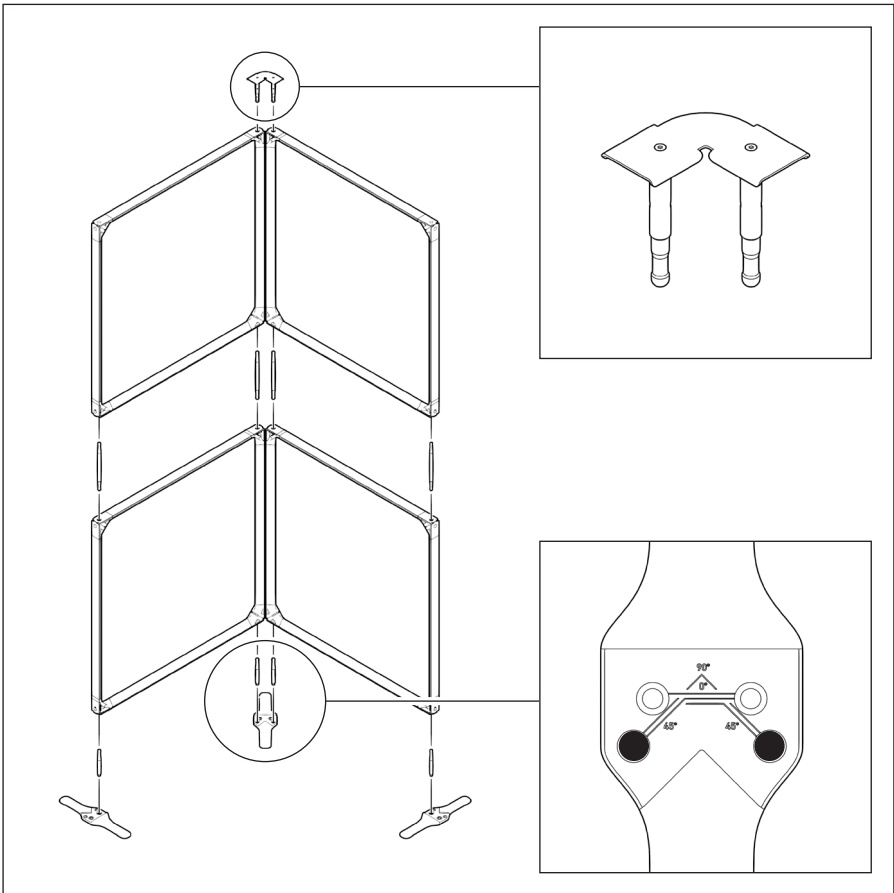

1. Fasten two **Foot rods** in the holes on the **Foot connector** marked "90°"
2. Mount two **Frames** onto the **Foot rods**
3. Insert **Connector rods** in the top holes of the **Frames**
4. Continue stacking **Frames** and **Connector rods** to the desired height
5. Place a **Top connector 90** on top

90° connection with Foot plate

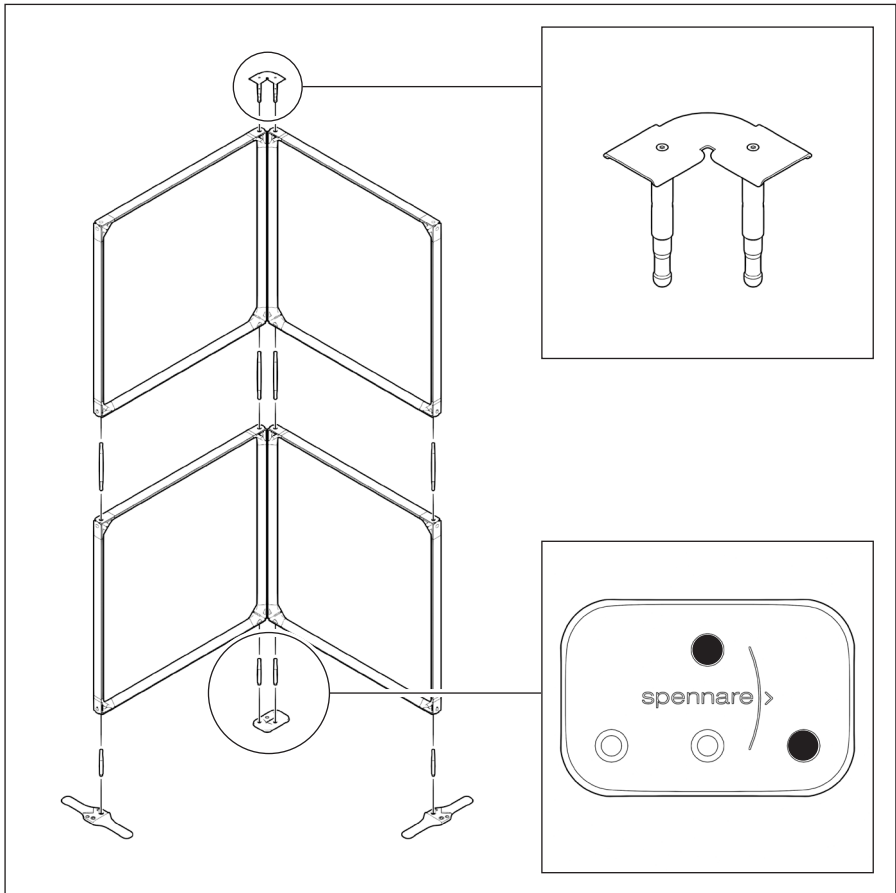

1. Fasten **Foot rods** in two of the outer holes on the **Foot plate**
2. Mount two **Frames** onto the **Foot rods**
3. Insert **Connector rods** in the top holes of the **Frames**
4. Continue stacking **Frames** and **Connector rods** to the desired height
5. Place a **Top connector 90** on top

T-connection with Foot plate

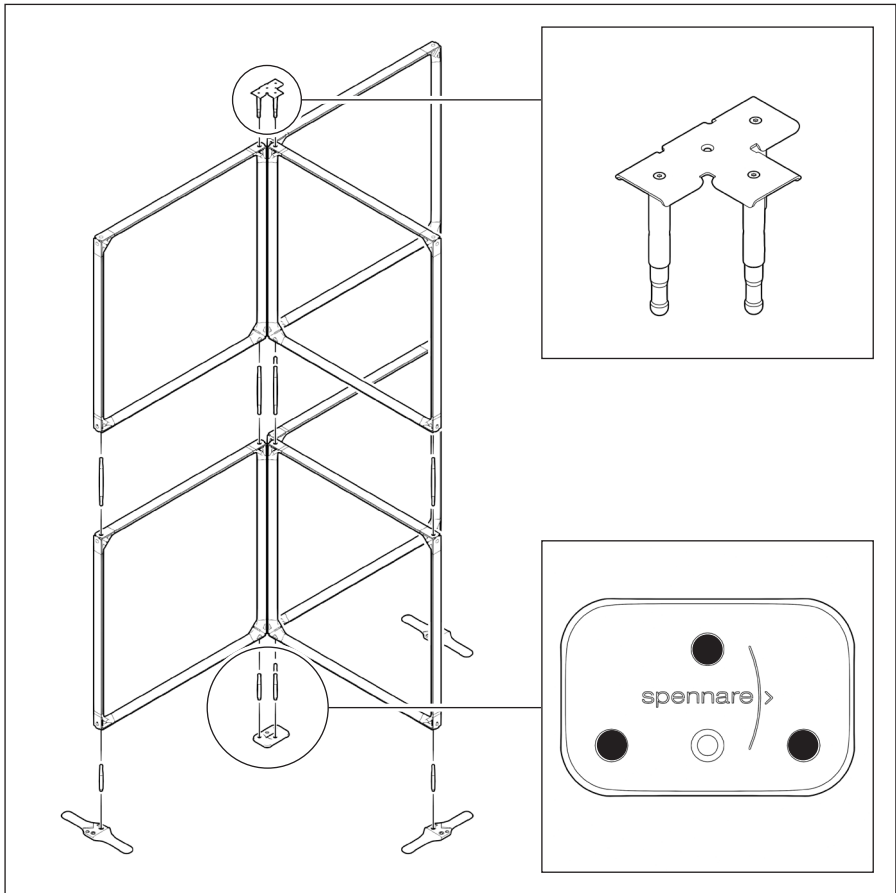

1. Fasten **Foot rods** in the three outer holes on the **Foot plate**
2. Mount three **Frames** onto the **Foot rods**
3. Insert **Connector rods** in the top holes of the **Frames**
4. Continue stacking **Frames** and **Connector rods** to the desired height
5. Place a **Top connector XT** on top

X-connection with Foot plate

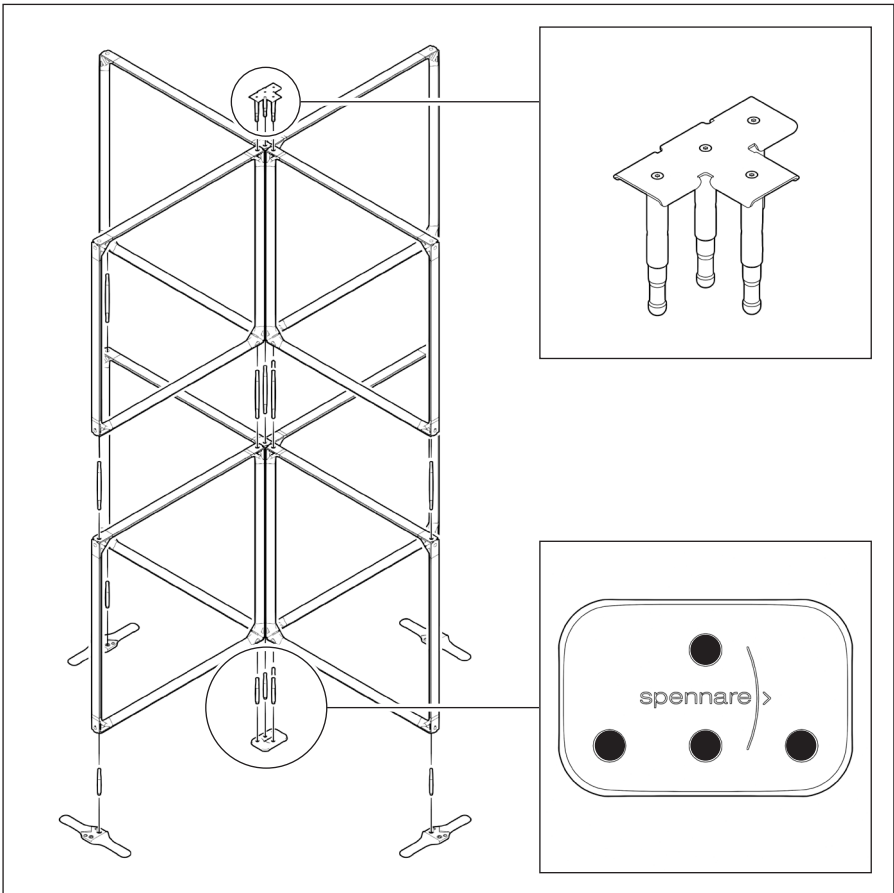

1. Fasten four **Foot rods** in the holes on the **Foot plate**
2. Mount four **Frames** onto the **Foot rods**
3. Insert **Connector rods** in the top holes of the **Frames**
4. Continue stacking **Frames** and **Connector rods** to the desired height
5. Place a **Top connector XT** on top

X-connection

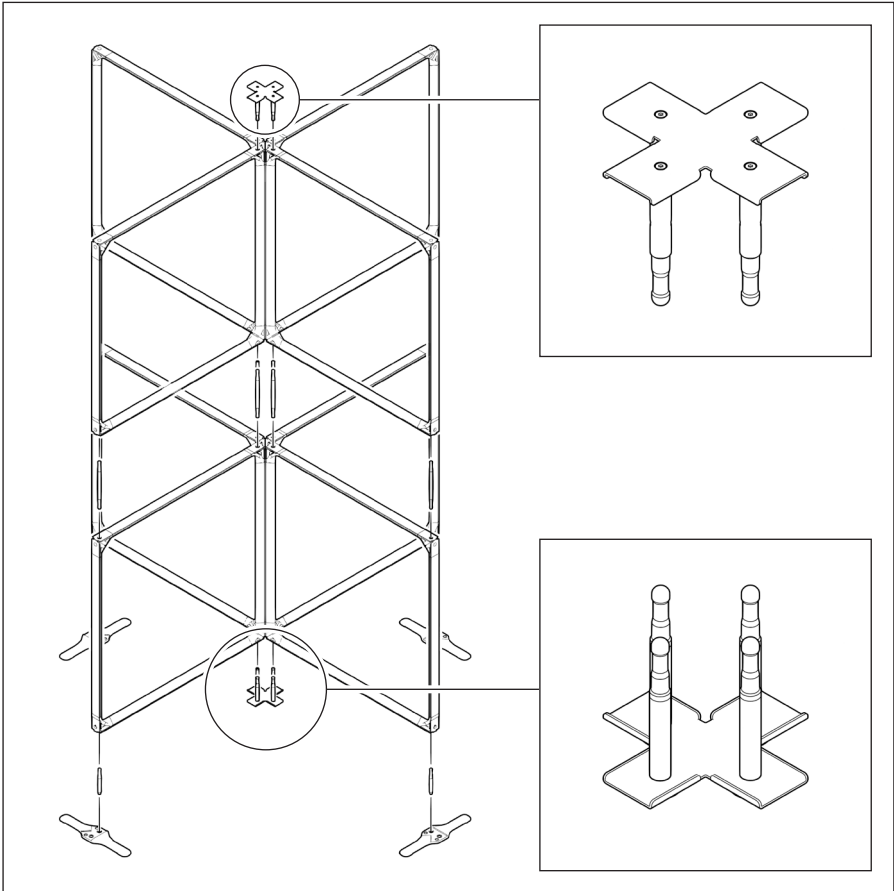

1. Assemble the **X-connection Foot connector**
2. Mount four **Frames** onto the **Foot rods**
3. Insert **Connector rods** in the top holes of the **Frames**
4. Continue stacking **Frames** and **Connector rods** to the desired height
5. Place a **Top connector X** on top

Y-connection

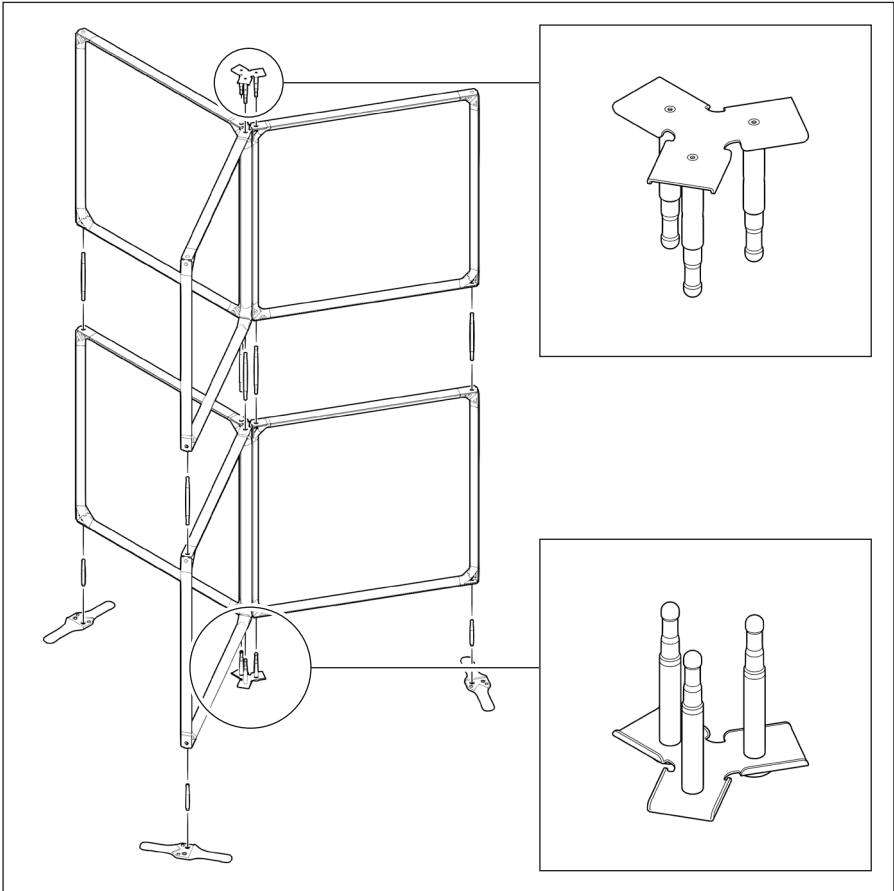

1. Assemble the **Y-connection Foot connector**
2. Mount three **Frames** onto the **Foot rods**
3. Insert **Connector rods** in the top holes of the **Frames**
4. Continue stacking **Frames** and **Connector rods** to the desired height
5. Place a **Top connector Y** on top

Curtain kit

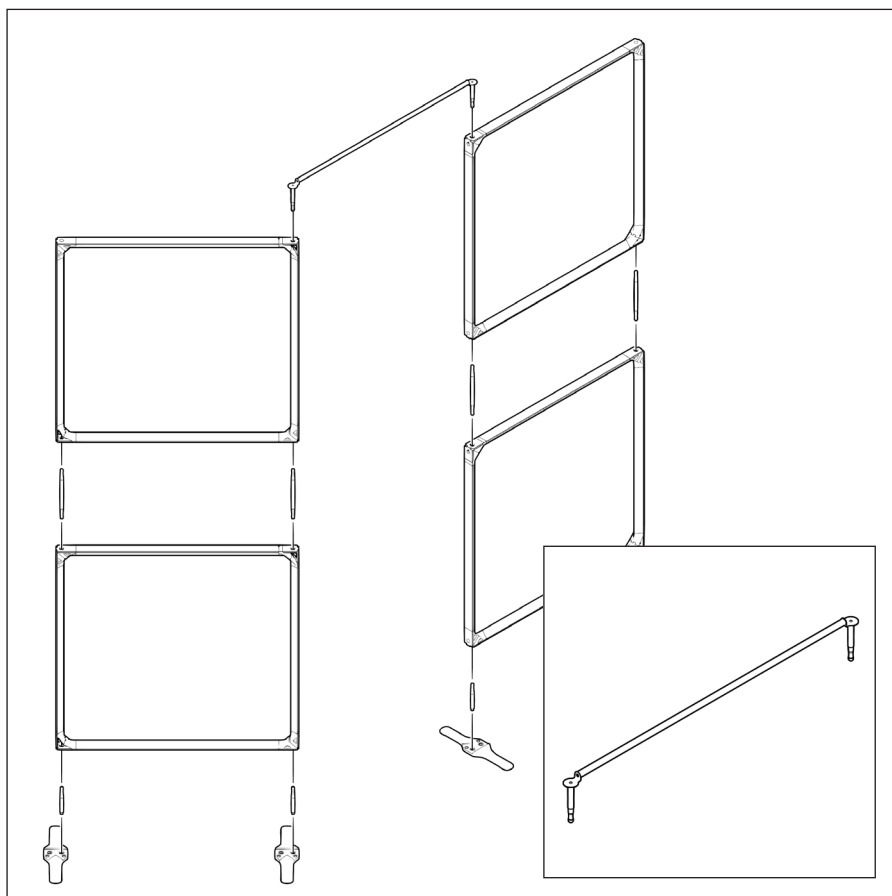

1. Hang the **Curtain fabric** on the **Curtain rod**
2. Screw the **Curtain brackets** into the **Curtain rod**
3. Place two **Frame stacks** sufficiently apart and mount the **Curtain rod** on top

Curtain kit

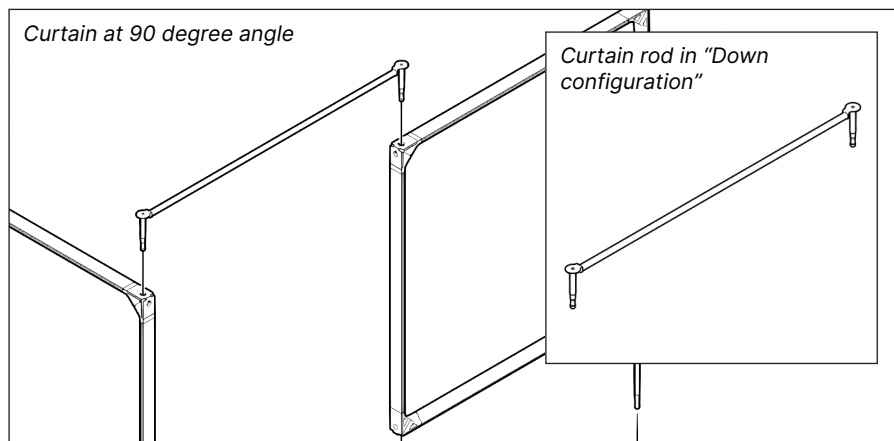

The **Curtain rod** assembled in the "**Down configuration**" allows a fixed position for the curtain; either in-line with the frames, or at a 90 degree angle.

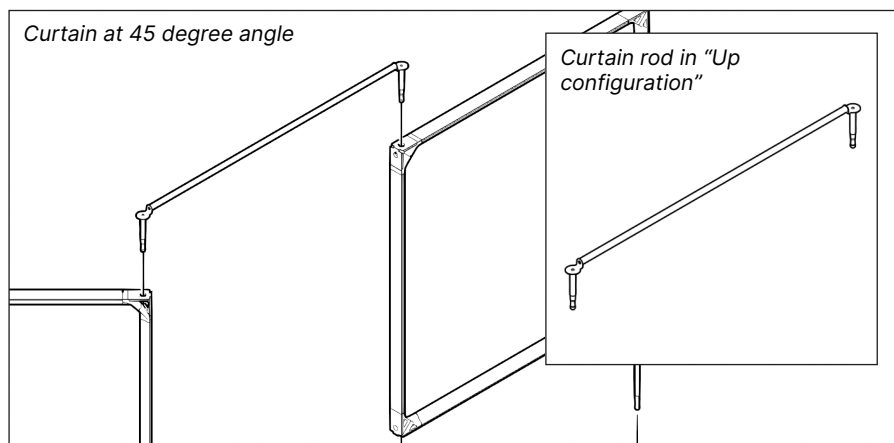

The **Curtain rod** assembled in the "**Up configuration**" allows the **Curtain rod** to rotate freely so the curtain can be placed at any angle.

Desk kit

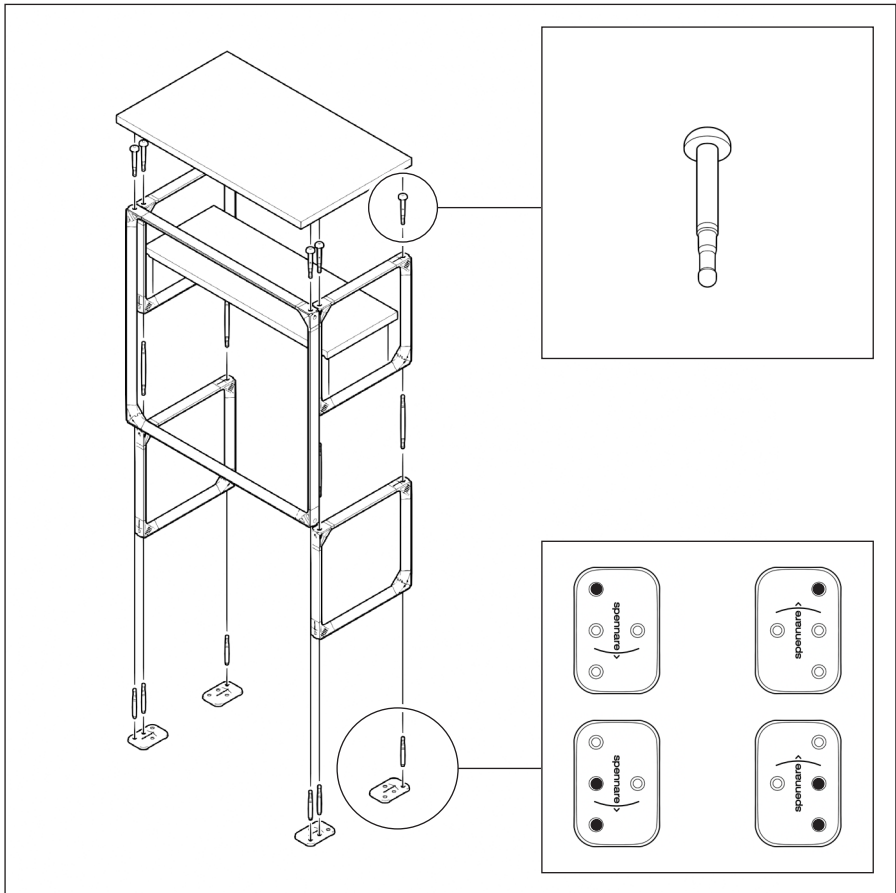

1. Fasten **Foot rods** in the **Foot plates** according to the pattern above
2. Mount the **Large frame** and two of the **Small frames** onto the **Foot rods**
3. Insert **Connector rods** in the top holes of the **Small frames** and mount the other two **Small frames**
4. Insert six **Rod with rubber foot** in the top holes of the **Frames** and mount the **Desk top** on top

Wall mounting kit

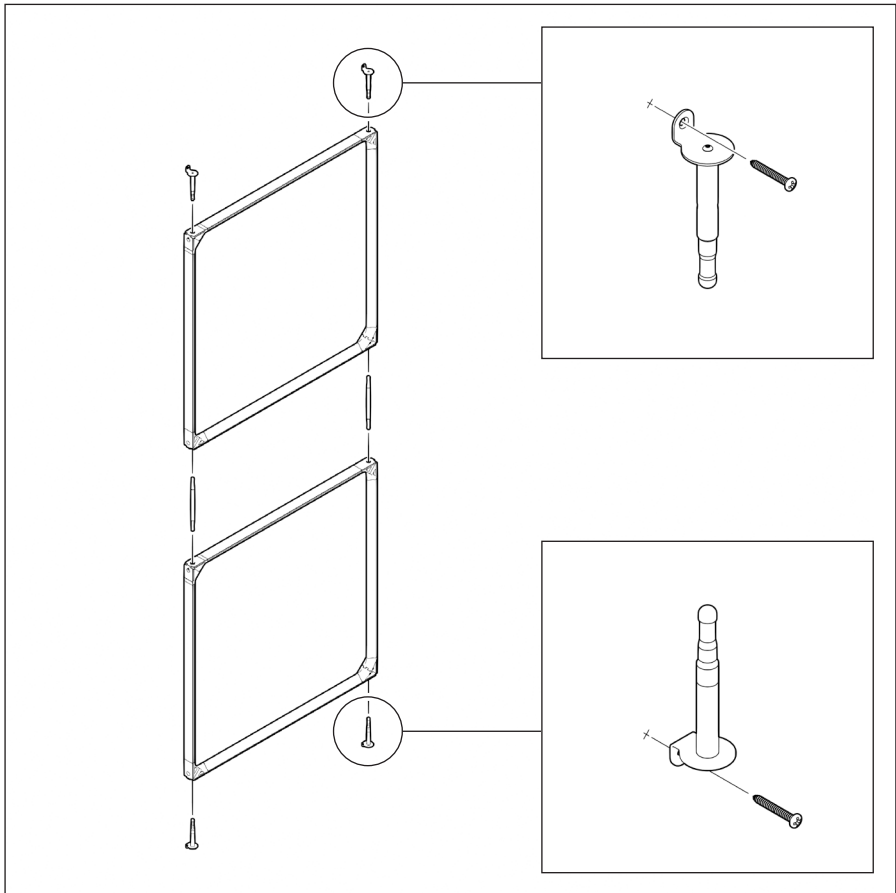

1. Fasten the bottom **Wall mounts** on the wall
2. Mount a **Frame** onto the **Wall mounts**
3. Insert two **Connector rods** in the top holes of the **Frame**
4. Continue stacking **Frames** and **Connector rods** to the desired height
5. Insert two **Wall mounts** in the top holes of the top **Frame** and then fasten them onto the wall

Illumination kit

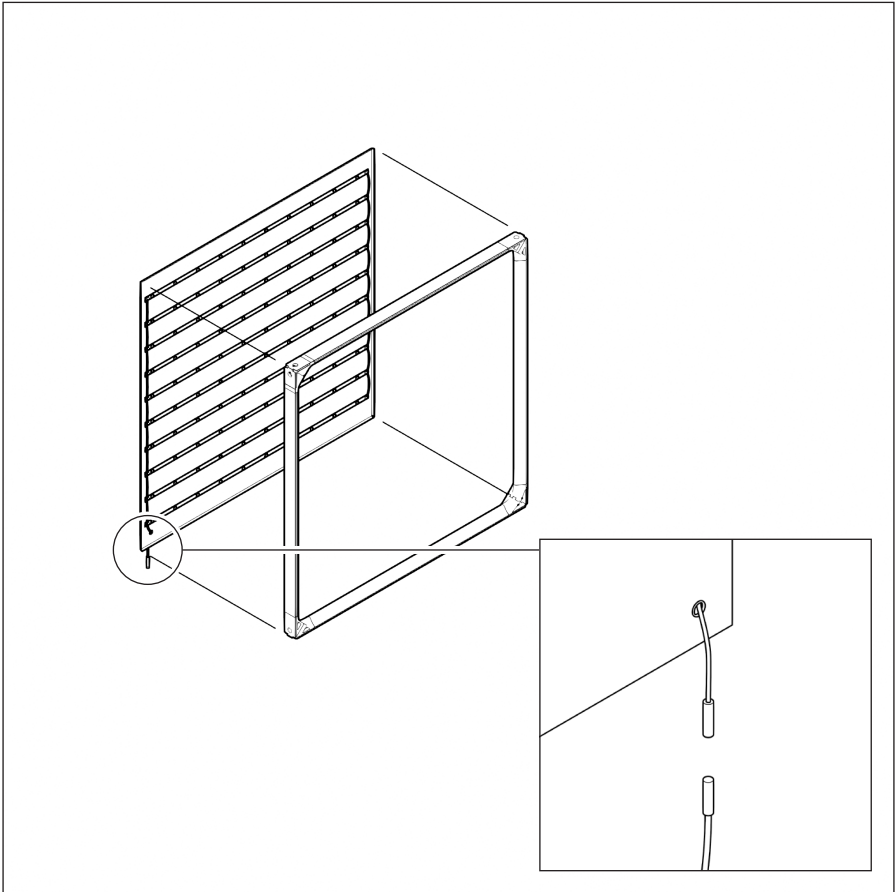

1. Mount the **LED matrix** on the backside of the desired **Flextile Frame**
2. Mount the desired **Fabric print** on the front of the **Frame**
3. Connect the **Transformer** cable to the **LED matrix** and a nearby power outlet

Components

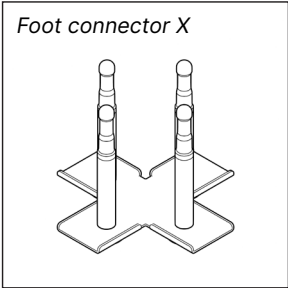
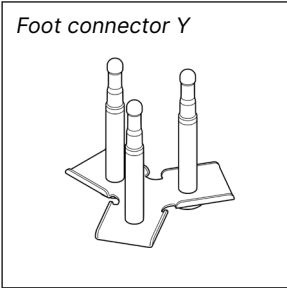
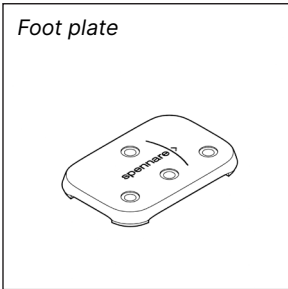
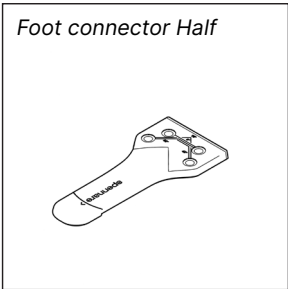
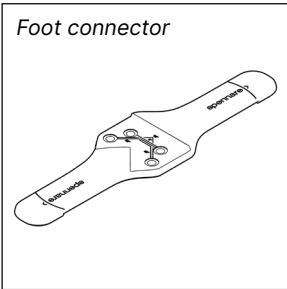
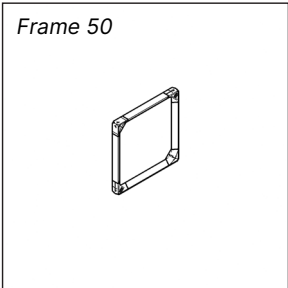
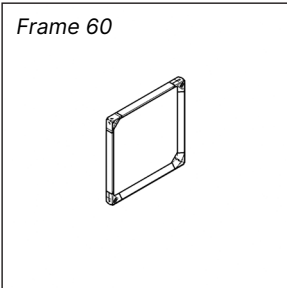
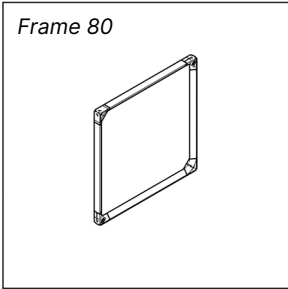
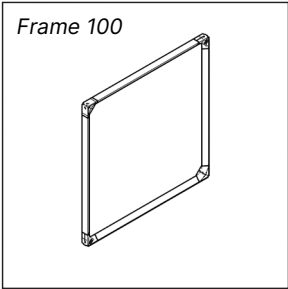
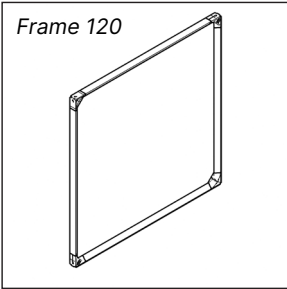

SYSTEM OVERVIEW

Components

Connector rod

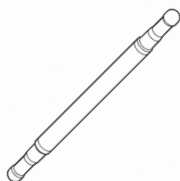

Foot rod



Foot rod IT



Wall mount bottom

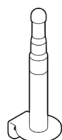

Wall mount top/Curtain mount

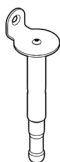

Rod with rubber foot

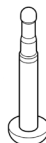

Top connector Straight

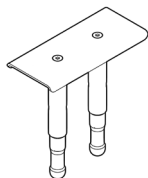

Top connector 45

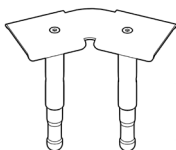

Top connector 90

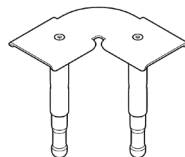

Top connector XT

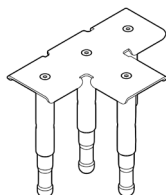

Top connector Y

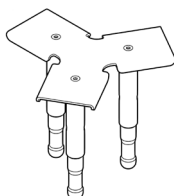

Top connector X

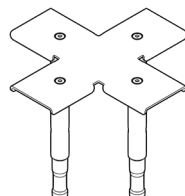

Components

Desk top

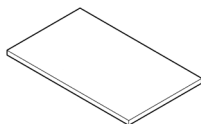

Desk shelf

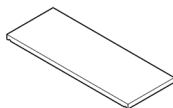

Curtain rod

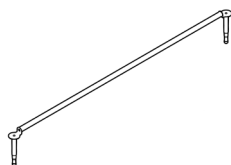

LED matrix

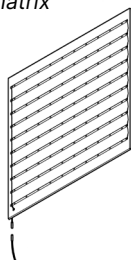

Flextile Assembly Instructions
Version 1. Copyright Spennare AB, 2024.

Spennare Headquarters:
Danvikcenter, Hästholmsvägen 32
131 30 Nacka
Sweden

+46 8 462 66 50 (switchboard)
info@spennare.com