

Set Up Instructions

Step 1: Assemble all straight pipes with bungee cords by pushing and pulling together.

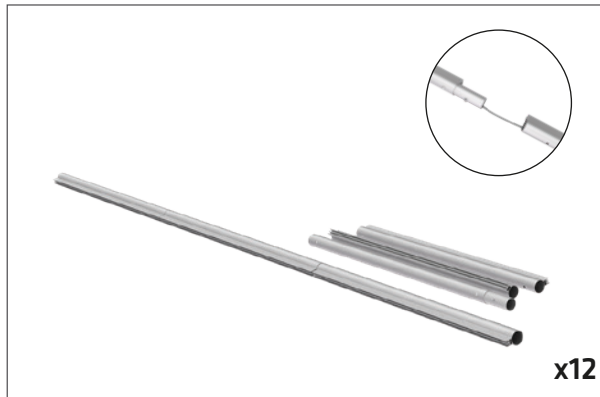

Step 2: Connect all corner sections to straight sections of the frame. Blue pipes represent the vertical pole position and should face up and down.

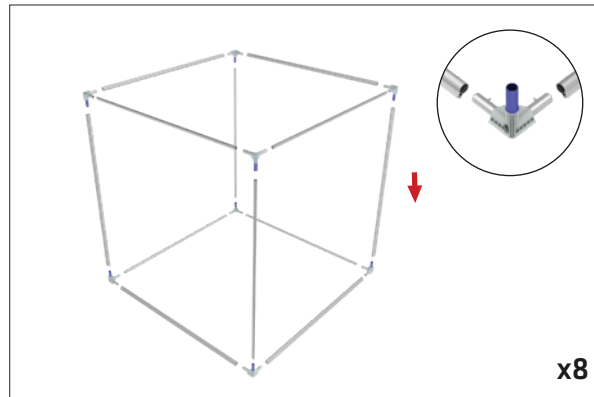

Step 3: At the top of the frame attach cable to opposite corners. Complete task twice to form an X.

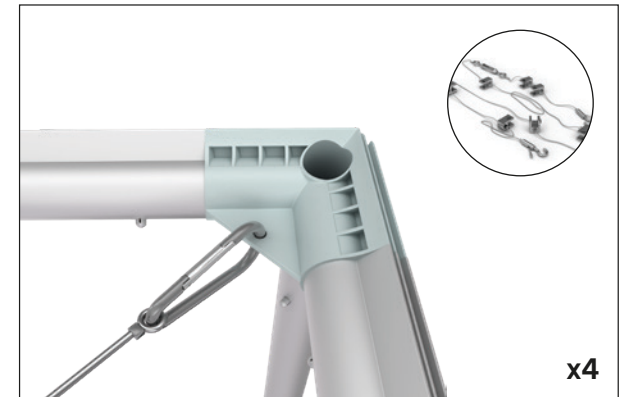

Step 4: Move to the center of cable and hand tighten turnbuckle to remove any remaining slack. Do not over tighten.

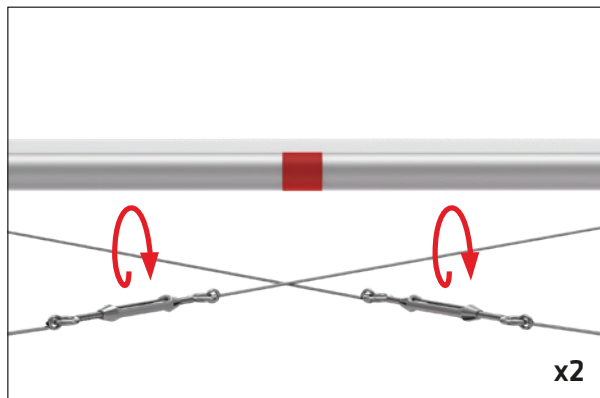

LED Light Arrays

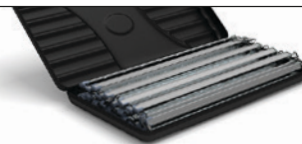

Step 5: Take out the LED Light Arrays and add to cable with power connector on top. The cable blocks can be adjusted by pushing the **pin into the block** and sliding the block along the cable into desired position.

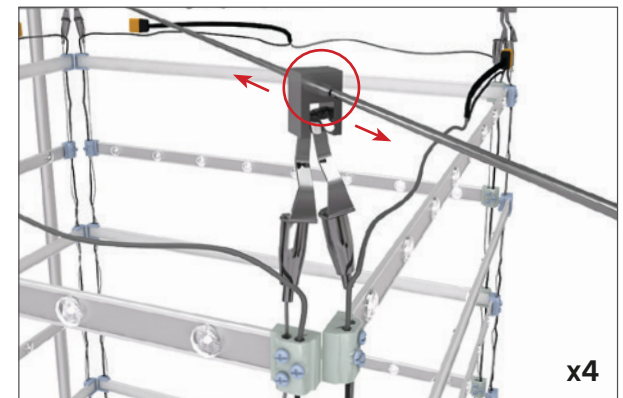
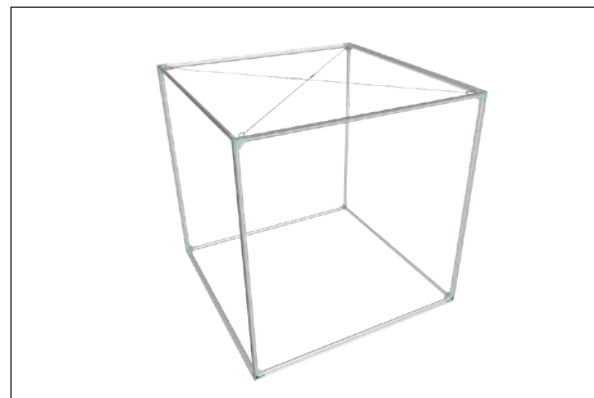

Set Up Instructions

Step 6: Completed vertical LED Light Arrays assembly.

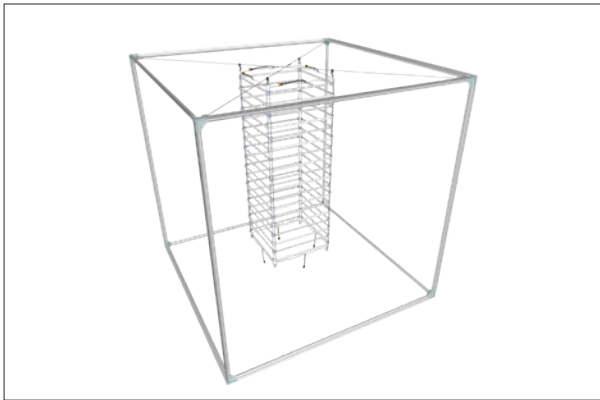

Step 7: Attach bottom horizontal LED Light Array to 4 corners of vertical LED Light Arrays.

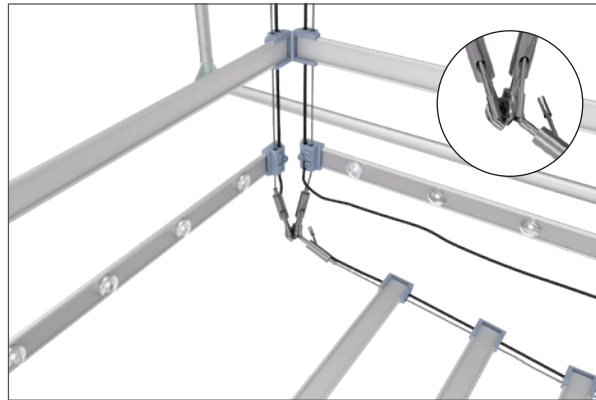

Step 8: Attach power cables between bottom and 1 vertical light array. Not all LED Light Arrays need to be plugged in at bottom. 3 plugs will hang freely.

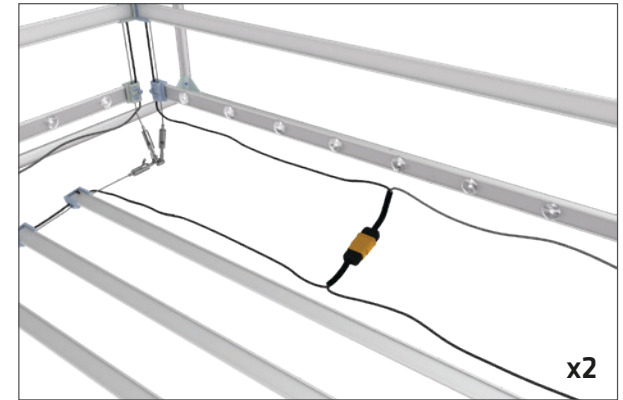

Use drop cloth on ground to prevent graphics from getting dirty!

Graphic Diagram

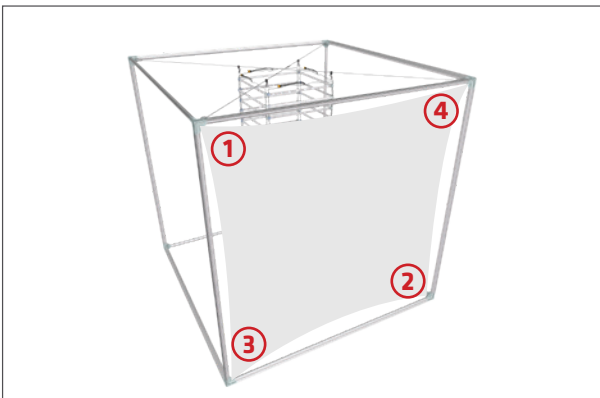

Step 9: Fold silicone edge graphics over an install into first corner of frame working outwards 4-6 inches. Repeat on remaining corners starting with the opposite corner. Follow the Graphic Diagram.

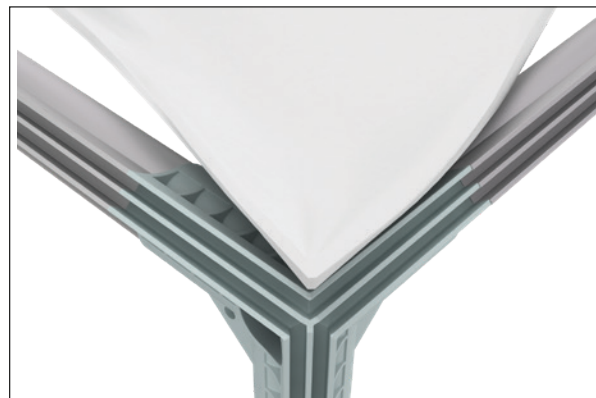

Step 10: Move to the center of each side of the frame to continue inserting the silicone edge graphics and work back toward the corners.

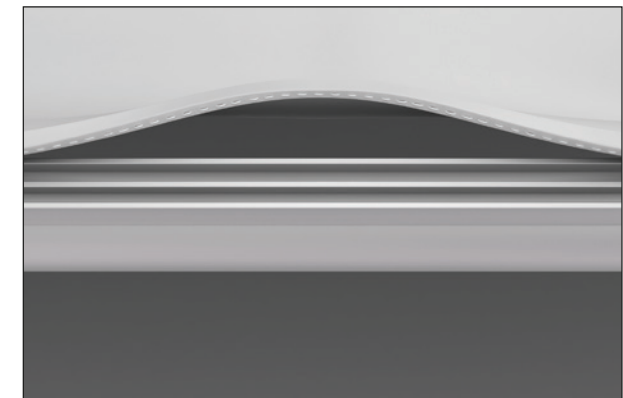

Set Up Instructions

Step 11: Repeat Steps 9-10 on all 4 sides. Leave installation of bottom graphic until after the display has been wired with harness and lifted overhead into a position where it can be installed from the ground.



Step 12: Attach wiring harness to the same carabiners in 4 corners used for the light cables.

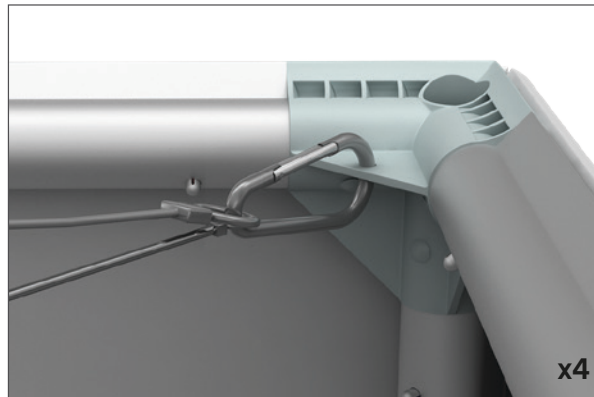

Step 13: Attach power supplies to hanging harness. Plug power supplies to the top of LED Light Arrays. 2 LED Light Arrays per 1 power supply.

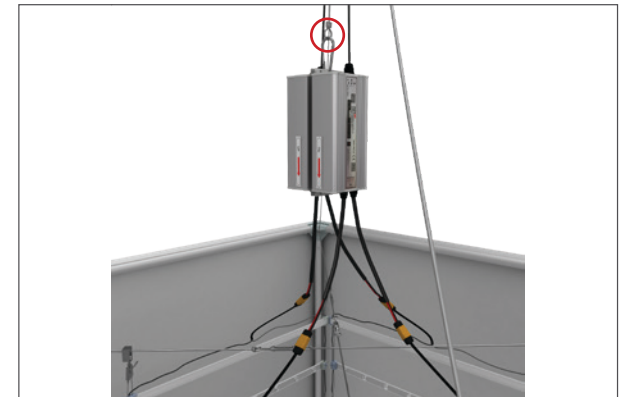

Step 14: Test lights if possible to make sure it has been wired properly.

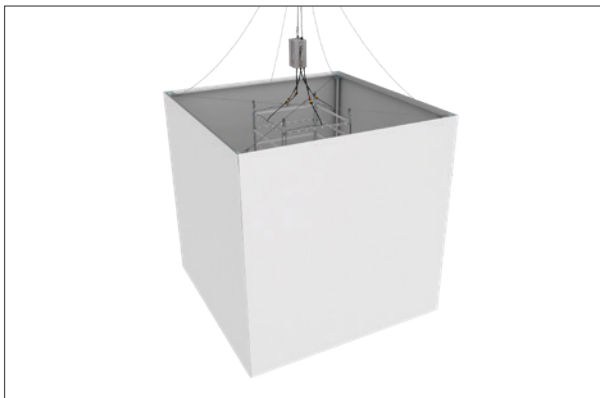

Step 15: Lift display into position and install bottom graphic following Steps 9-10.

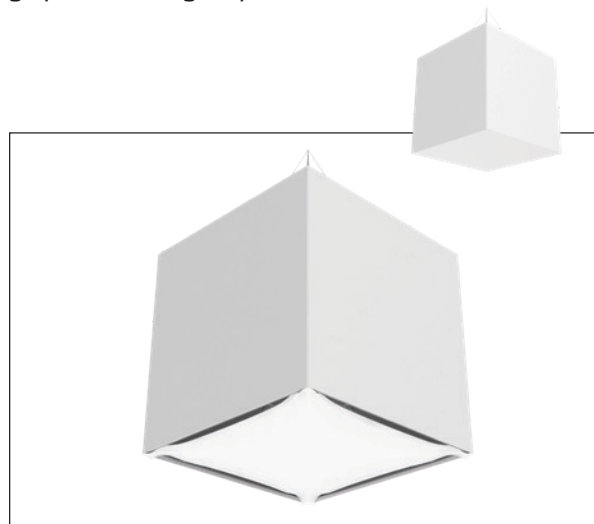

CAUTION!

Do not connect lights to power when lights are rolled up. Hang lights on frame before connecting to power for testing.

